

REV. NO.	DESCRIPTION	REVISIONS	DATE

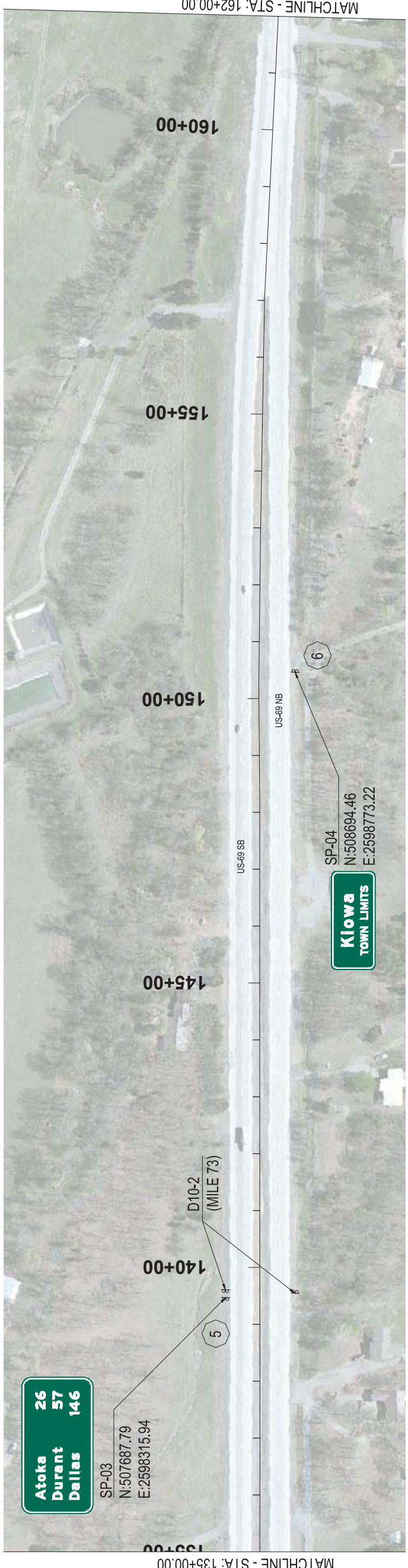

MATCHLINE - STA: 135+00.00



MATCHLINE - STA: 162+00.00



1000 WEST WILSHIRE BLVD.
SUITE 403-E
OKLAHOMA CITY, OK 73116
PHONE: (405) 384-5127

US - 69
DIVISION 2

PITTSBURG COUNTY

SIGNING PLAN
STA: 135+00 TO STA: 189+00

State Job No. 33252(04) Sheet No. 61 OF 123